



QUEEN MARY 2 DECK PLANS

MAY 2013 - JANUARY 2014 VOYAGES

Stateroom Category

Grand Duplexes Aft High Deck 9	Q1
Duplexes & Suites Forward/Aft High Decks 9,10	Q2
Royal Suites Forward High Deck 10	Q3
Penthouse Midships/Aft High Decks 9,10	Q4
Queens Suites Midships High Decks 9,10,11	Q5
Forward High Decks 9,10	Q6
Midships High Decks 8,9	Q7
Princess Suites Midships High Deck 10	P1
Forward High Deck 10	P2
Club Balcony Midships High Deck 12	AA
Forward High Deck 12	AC
Balcony Midships High Decks 8,11	BA
Forward High Decks 8,11,12	BC
Balcony (sheltered) Midships Low Decks 4,5,6	BB
Forward/Aft Low Decks 4,5,6	BD
Balcony (obstructed view) [†] Midships High Deck 8	DA
Forward High Deck 8	DC
Oceanview Forward/Aft Low Decks 4,5,6	ED
Atrium View Inside Midships Low Decks 5,6	HB
Standard Inside Midships High Decks 10,11,12	IA
Midships Low Decks 4,5,6	IB
Forward High Decks 9,10,11,12	IC
Forward/Aft Low Decks 4,5,6	ID

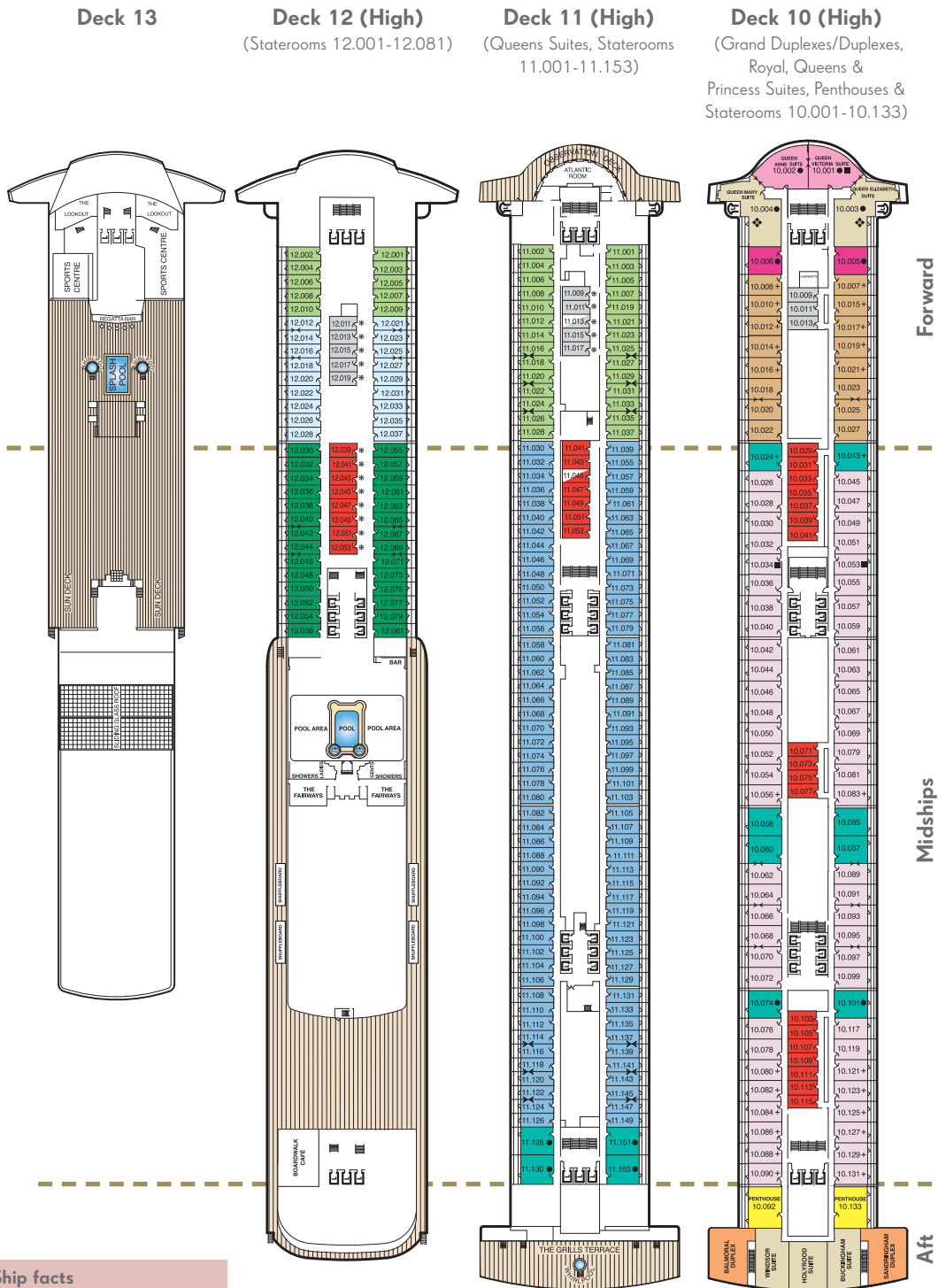

Key to symbols

- L** Lift
- ↔ Connecting staterooms
- + 3rd berth is a single sofa bed
- 3rd & 4th berth is a double sofa bed
- * 3rd & 4th berths are two upper beds
- † Staterooms have views obstructed by lifeboats
- Wheelchair accessible (stateroom sizes vary)
- ◇ Single level Q2 Suite

Ship facts

Entered Service:	2004
Refit:	November 2011
Country of Registry:	Bermuda
Speed:	28 knots
Gross Tonnage:	151,400 GRT
Guest Capacity:	2,620
No of Crew:	1,253
Length:	1,132 feet
Width:	131 feet
Draft:	32 feet



QUEEN MARY 2 DECK PLANS

MAY 2013 - JANUARY 2014 VOYAGES

Stateroom Category

- Grand Duplexes
Aft High Deck 9
- Duplexes & Suites
Forward/Aft High Decks 9,10
- Royal Suites
Forward High Deck 10
- Penthouse
Midships/Aft High Decks 9,10
- Queens Suites
Midships High Decks 9,10,11
- Forward High Decks 9,10
- Midships High Decks 8,9
- Princess Suites
Midships High Deck 10
- Forward High Deck 10
- Club Balcony
Midships High Deck 12
- Forward High Deck 12
- Balcony
Midships High Decks 8,11
- Forward High Decks 8,11,12
- Balcony (sheltered)
Midships Low Decks 4,5,6
- Forward/Aft Low Decks 4,5,6
- Balcony (obstructed view)[†]
Midships High Deck 8
- Forward High Deck 8
- Oceanview
Forward/Aft Low Decks 4,5,6
- Atrium View Inside
Midships Low Decks 5,6
- Standard Inside
Midships High Decks 10,11,12
- Midships Low Decks 4,5,6
- Forward High Decks 9,10,11,12
- Forward/Aft Low Decks 4,5,6

- Q1
- Q2
- Q3
- Q4
- Q5
- Q6
- Q7
- PI
- P2
- AA
- AC
- BA
- BC
- BB
- BD
- DA
- DC
- ED
- HB
- IA
- IB
- IC
- ID

Key to symbols

- L Lift
- Connecting staterooms
- + 3rd berth is a single sofa bed
- 3rd & 4th berth is a double sofa bed
- * 3rd & 4th berths are two upper beds
- † Staterooms have views obstructed by lifeboats
- Wheelchair accessible (stateroom sizes vary)
- ◇ Single level Q2 Suite

Deck 9 (High)

(Grand Duplexes/Duplexes, Penthouses, Queens Suites & Staterooms 9.001-9.082)

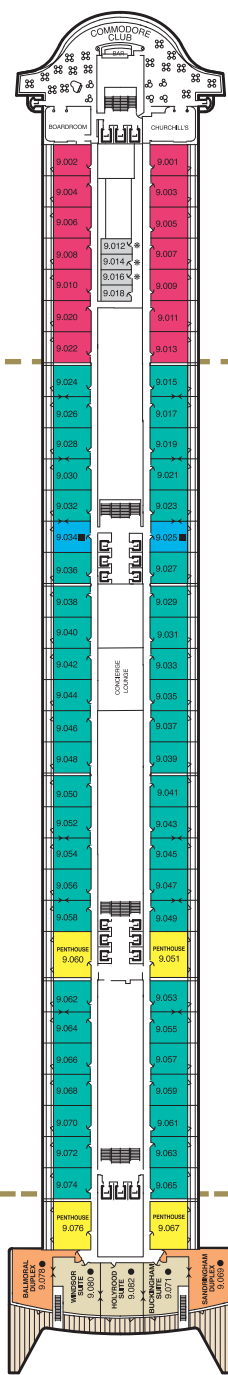

Deck 8 (High)

(Queens Suites & Staterooms 8.001-8.130)

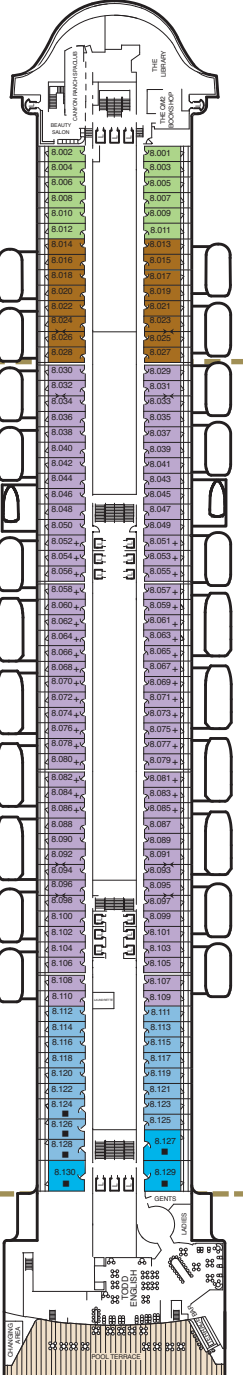

Deck 7

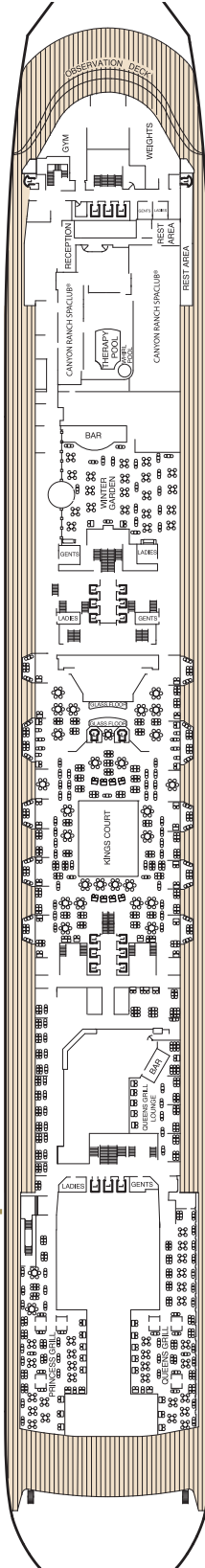

Deck 6 (Low)

(Staterooms 6.001-6.304)

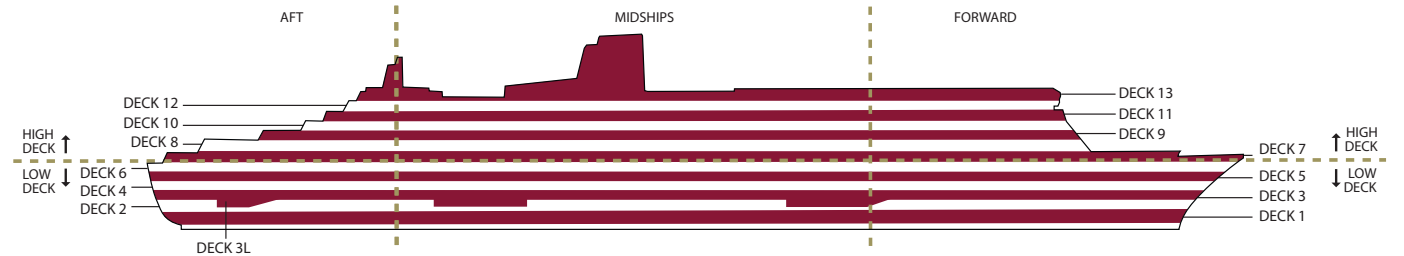
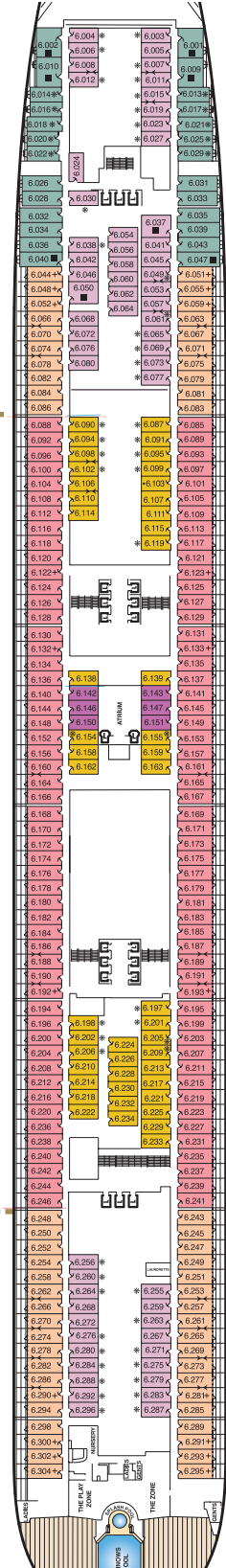

Deck 5 (Low)

(Staterooms 5.001-5.269)

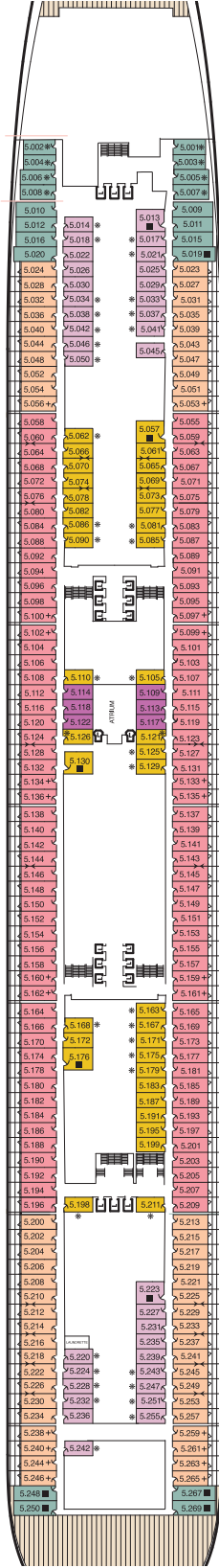

Deck 4 (Low)

(Staterooms 4.001-4.225)

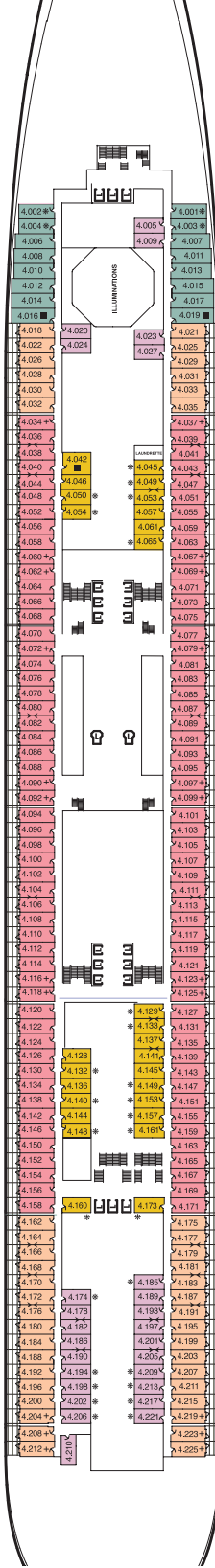

Deck 3 & 3L

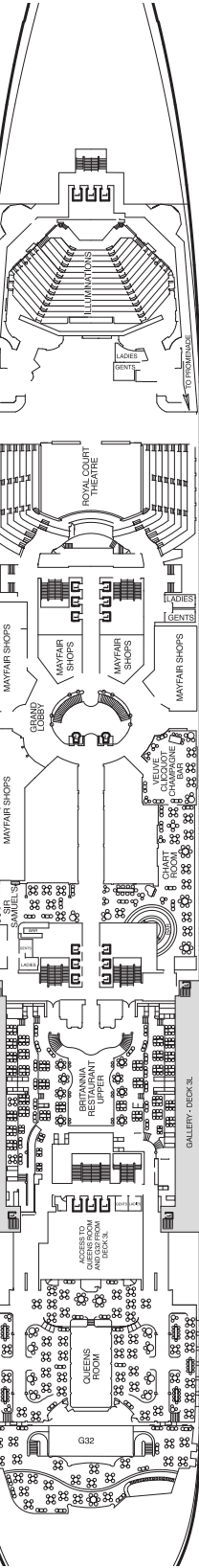

Deck 2 & 3L

